

MAORI

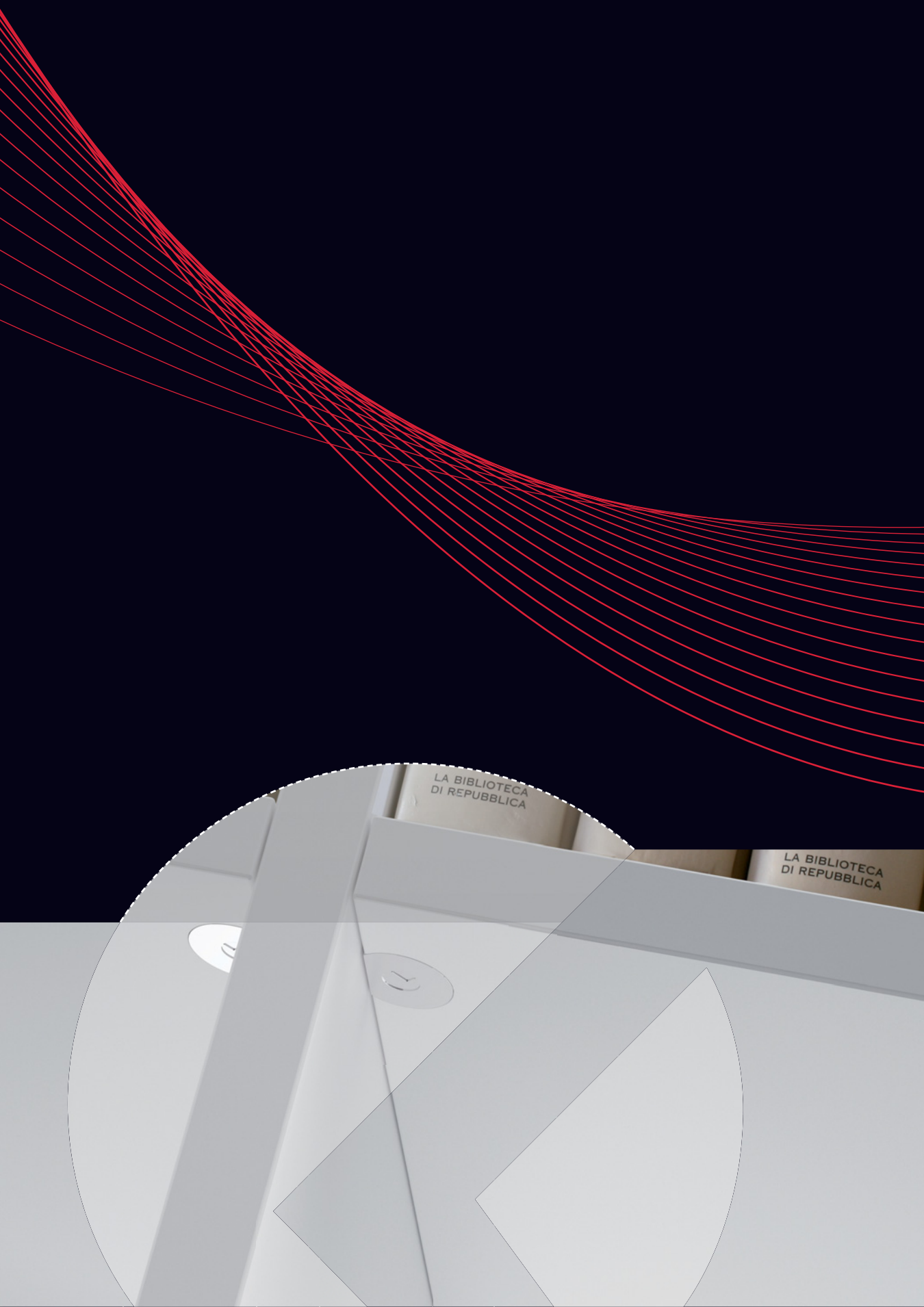

SHELF
SUPPORTS





SYMBOLS AND FINISHES LEGEND

SYMBOLS

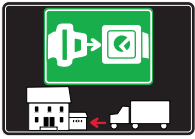

= SHELF SAFELY LOCKED DURING TRANSPORTATION AND AT HOME.



= ANTI-TURNOVER LOCKING SYSTEM



= NORMS / PATENTS



= PHILLIPS / POZIDRIV



= NEWTON



= PART.NO



= HEXAGONAL SOCKET



= FRICTION



= PCS. PER PACKAGE



= BLADE SLOT



= AUTOMATIC



= COMBI SLOT



= DROP DOWN



= CAPACITY LOADING



= COUNTERSUNK HEAD



= WOOD / GLASS THICKNESS



= PAN HEAD



= STANDARD HINGE



= HOLE DIAMETER



= FLANGE HEAD



= KIMANA HINGE



= DIAMETER



= FLAT HEAD



= FLAP HINGE



= LENGTH



= TRILOBULAR SCREW



= WITH SPRING



= HEIGHT



= SELF-TAPPING SCREW



= WITHOUT SPRING



= RIGHT VERSION



= EURO THREAD



= REVERSED SPRING



= LEFT VERSION



= METRIC THREAD



= PRE-INSERTED SCREW



= FOR ROUND TUBE



= PCS. PER PAD



= PRE-INSERTED SCREW AND SPREADING BUSH



= FOR OVAL TUBE



= CUT ON REQUEST



= WITH BUFFER



= SELF ADHESIVE



= WITH MAGNET



= WITH FLANGE

MATERIALS

ZA = Zinc Alloy	ST = Steel	HSS = High Speed Steel	BR = Brass	ABS = Acrylonitrile Butadiene Styrene
ZAnk = Nickel-plated Zinc Alloy	STzk = Zinc-plated Steel	AL = Aluminium	WD = Wood	EVA = Ethylene Vinyl Acetate

EP = **ENGINEERING PLASTIC**

+ **EP** = other engineering plastic available on request

SR = **SOFT RUBBER**

+ **SR** = other soft rubber available on request

EPn = Natural Engineering Plastic	EPc = Clear Engineering Plastic	SRn = Natural Soft Rubber
EPw = White Engineering Plastic	EPg = Grey Engineering Plastic	SRw = White Soft Rubber
EPwg = Water Green Engineering Plastic		SRb = Black Soft Rubber

FINISHES

+  = OTHER FINISHES AVAILABLE ON REQUEST

PART. NO	FINISHES	PART. NO	FINISHES	PART. NO	FINISHES
AA	Natural	JB	Bright Aluminium	PZ	Beech
AB	White	JC	Aluminium - Chrome	QA	Maple
AC	Opal White	JD	Matt Aluminium	QB	Walnut
AE	White 9010	JE	Satin-finished Aluminium	WA	Bronzed
AK	Champagne	JF	Aluminium - Brass	WI	Burnished
AL	Ivory	JG	Aluminium 5	XD	Satin-finished Steel
EA	Black	JL	Aluminium PE 11	YA	Nickel-plated
EB	Glossy Black	JM	Aluminium RAL 9006	YB	Bright Nickel-plated
EC	Matt Black	KA	Chrome	YC	Matt Nickel-plated
GR	Raw	KB	Bright Chrome	YD	Satin-finished Nickel-plated
HA	Brass-Plated	KC	Matt Chrome	ZA	Zinc alloy
HH	Tropicalized	MA	Brown	ZN	Zinc-plated
HL	Raw Brass	MB	Light Brown 1	ZQ	Bright Gold
IA	Grey	NN	Metallic Beige	ZY	Titanium
IB	Metallic Grey	NO	Beige	ZZ	Clear
IF	Middle Grey	OA	Oak	00	Insignificant finish
IJ	Light Grey	OZ	Ash		
IL	Grey 20	PA	Light Ash		
JA	Aluminium	PY	Cherry		



MAORI

MAORI is the new concept in wood shelf supports, to be slotted into the panel by making face borings.

It is ideal for modular cabinets and modular furniture sporting a wide range of thicknesses. In fact MAORI can be used for the shelves minimum 12mm thick. The small side bracket round ledge flushes with the lower side of the shelf making it aesthetically very elegant.

The panel has to be pushed downwards onto the side brackets, which can be screwed into any position required. The side bracket slots into the socket of the shelf supports and a click locks the panel in position.

On the shelves >12mm thick, it is possible to fix the plastic support permanently using a Ø 3 mm screw.



12 mm min.

UNI EN 14749/05

INSTALLATION AND ASSEMBLING

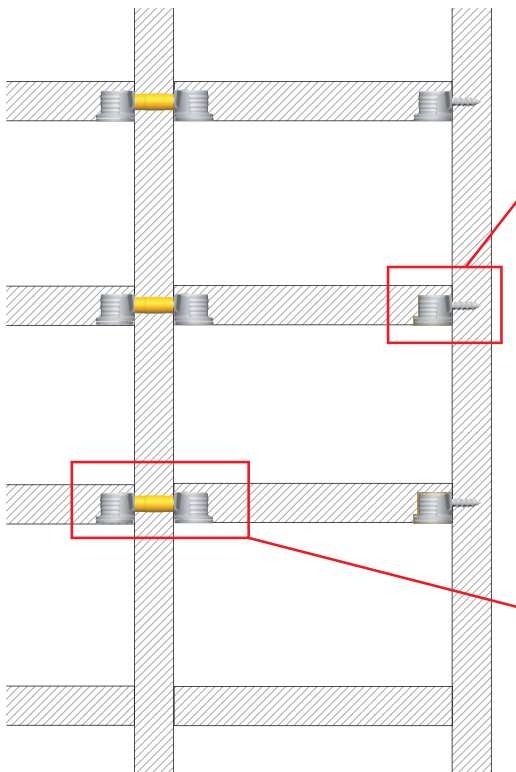
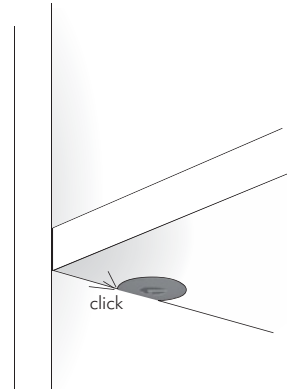
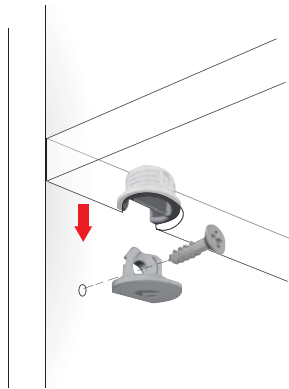
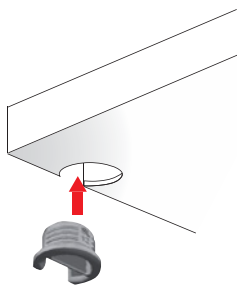

Assembling with alternative fixing options.

Assembling with pre-inserted spreading bush and screw to avoid hole damaging for shelf repositioning.

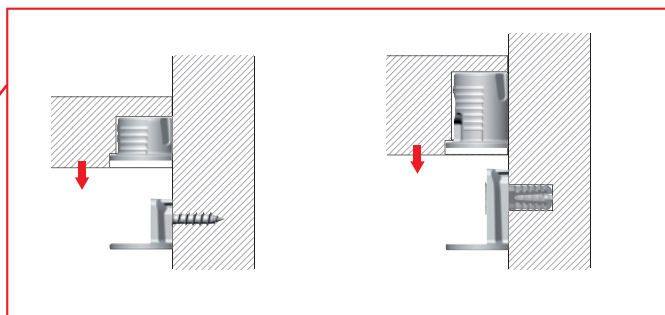

SPECIAL APPLICATION FOR SIDE PANEL 12 mm THICK:

Through hole fixing with metric sleeve.

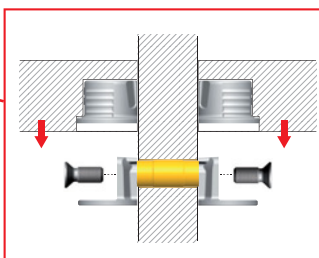

OPTIONAL FIXING (12mm thick version excluded):

To achieve much more horizontal connection.

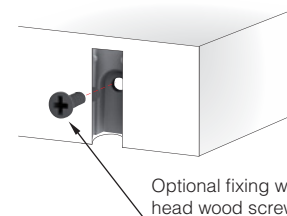

Optional fixing with countersunk head wood screw Ø 3 x 16 mm.

Also suitable for top and bottom panels when a back panel is used.





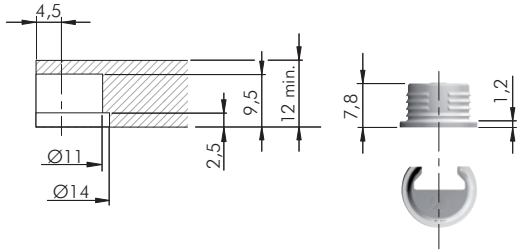

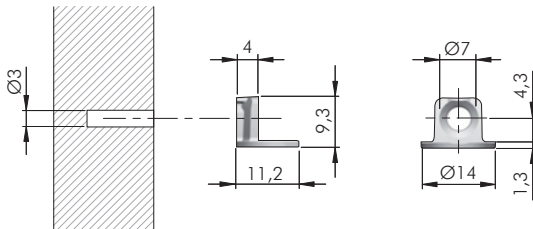

MAORI  **12 mm**









EP	 = 30.000 pcs.
 123 	
11701010IL	

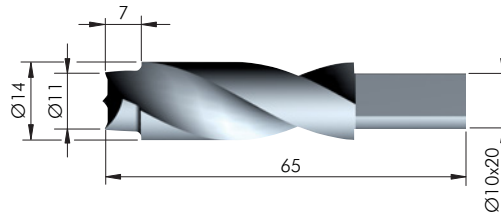
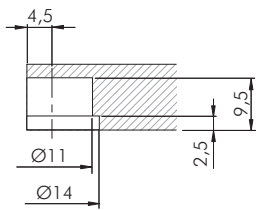

 = Ø 3 mm	 + 
ZA	 = 5000 pcs.
 123 	
11702010YA	

DRILL BIT FOR MAORI  **12 mm**



HSS	 = on request
 123 	
1175201000 	
1175205000 	

MAORI  **16 mm**

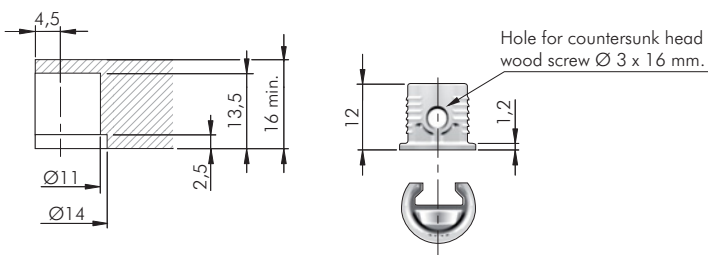

EP	 = 5000 pcs.
 123 	
11701040IL	

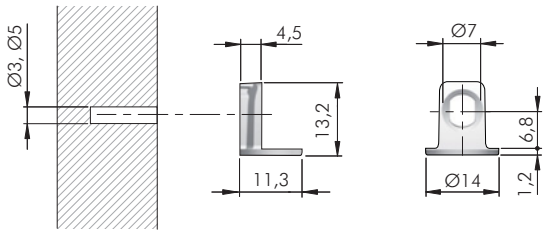

= Ø 3, Ø 5 mm



ZA

= 5000 pcs.



11704010YA

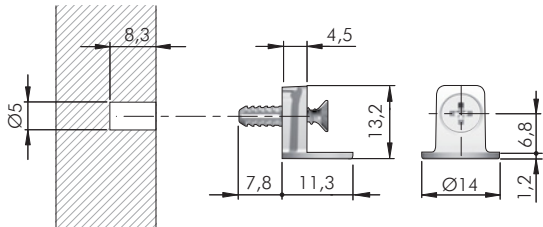

= Ø 5 mm



= PZ2

ZA

ST

EP

= 2500 pcs.



11704030YA

DRILL BIT FOR MAORI 16 mm

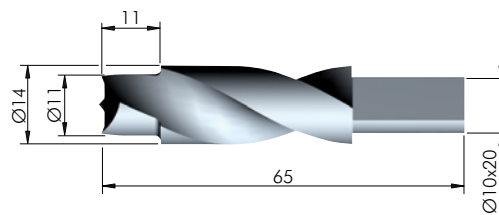
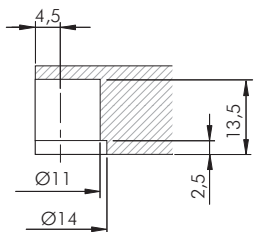

HSS

= on request



1175202000

R

1175206000

L

MAORI 18 - 19 mm

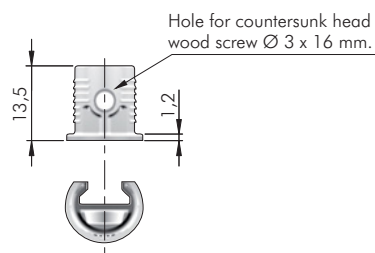
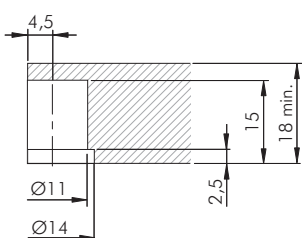

EP

= 20.000 pcs.



11701070IL

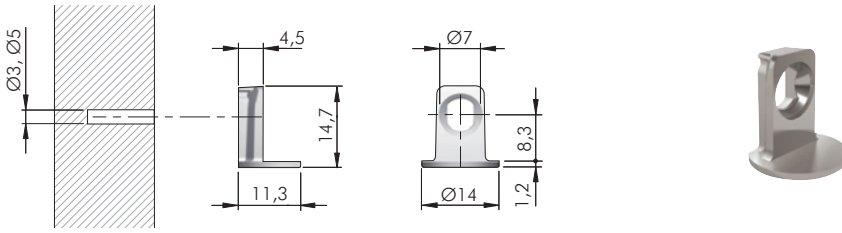

= Ø 3, Ø 5 mm +

= 5000 pcs.

11710010YA

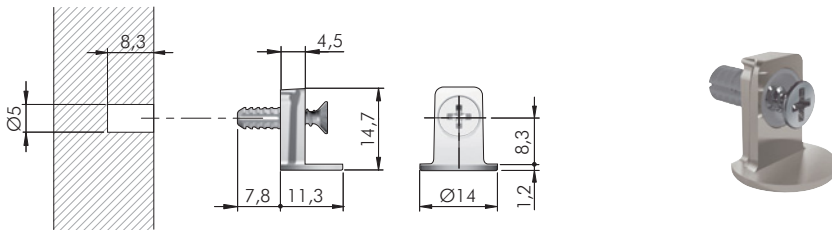

= Ø 5 mm +

= PZ2

= 5000 pcs.

11710030YA

DRILL BIT FOR MAORI 18 - 19 mm

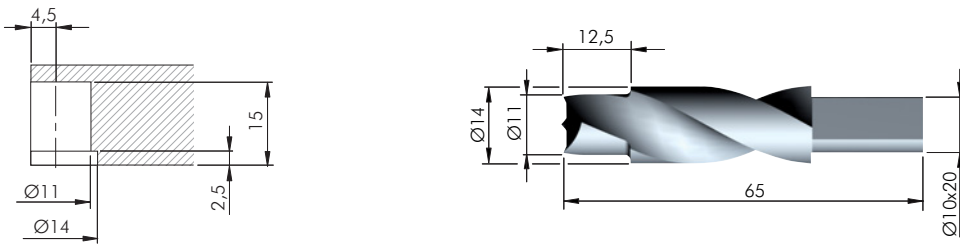

= on request

1175203000

1175207000

MAORI 25 mm

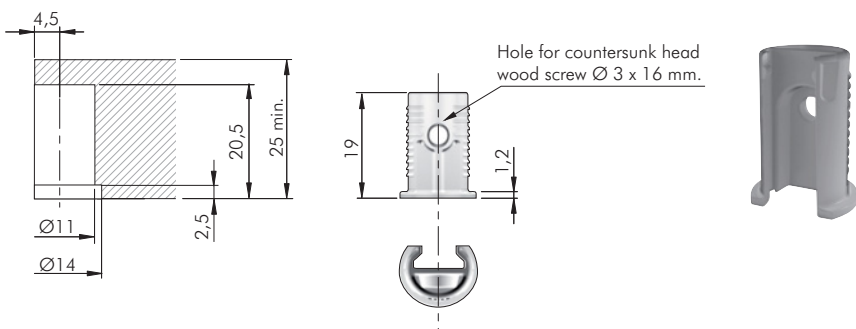

= 10.000 pcs.

11701100IL

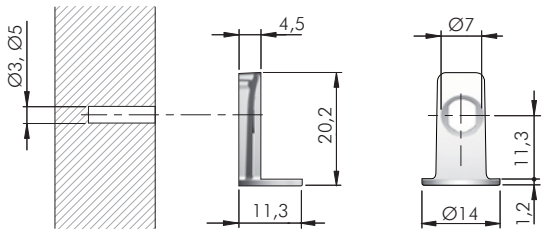

= Ø 3, Ø 5 mm +

ZA = 2500 pcs.



11716010YA

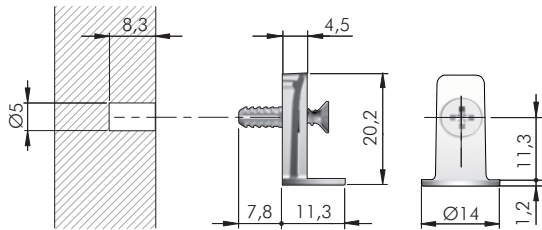

= Ø 5 mm +

= PZ2

ZA ST EP = 2500 pcs.



11716030YA

MAORI 29 mm

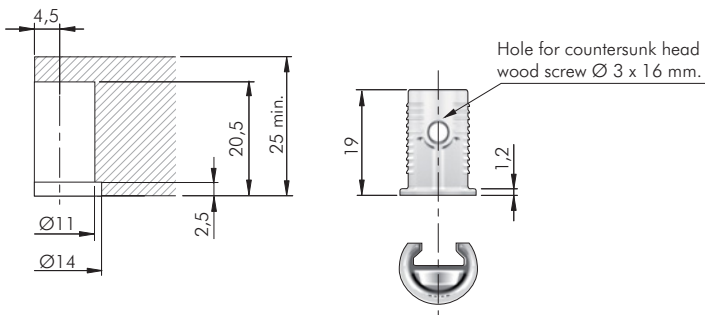

EP = 10.000 pcs.



11701100IL

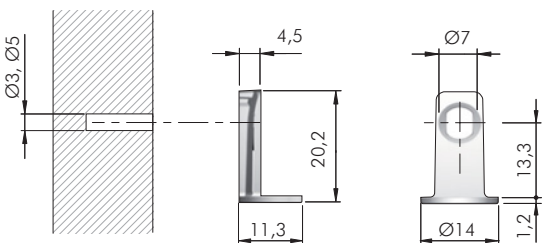

= Ø 3, Ø 5 mm +

ZA = 5000 pcs.



11722010YA

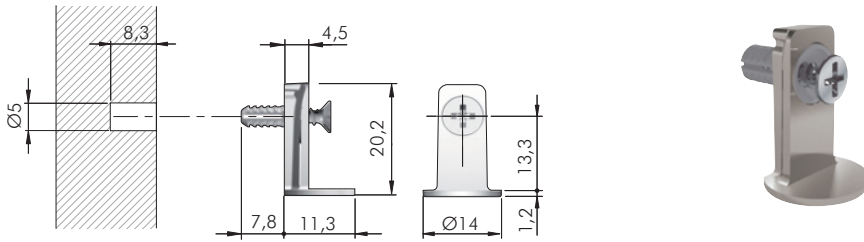

= Ø 5 mm +
 = PZ2
 ZA ST EP = 2500 pcs.

123
 11722030YA

DRILL BIT FOR MAORI 25, 29 mm

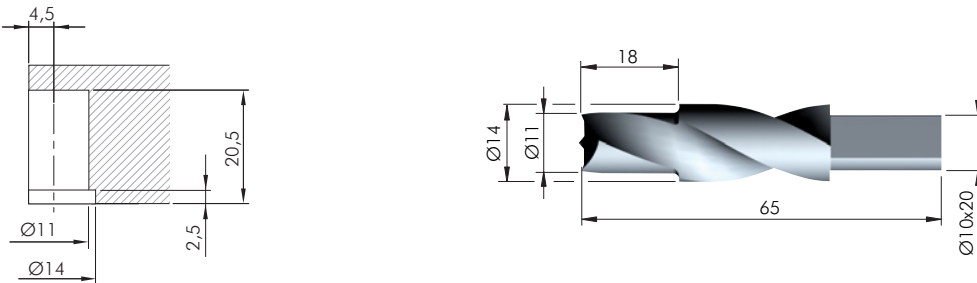

HSS = on request

123
 1175204000
 1175208000

MAORI FIXING ACCESSORIES

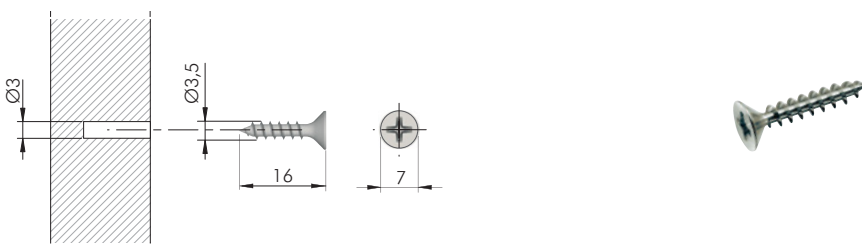

= Ø 3 mm +
 = PZ2
 ST = 10.000 pcs.

123
 60101390ZN

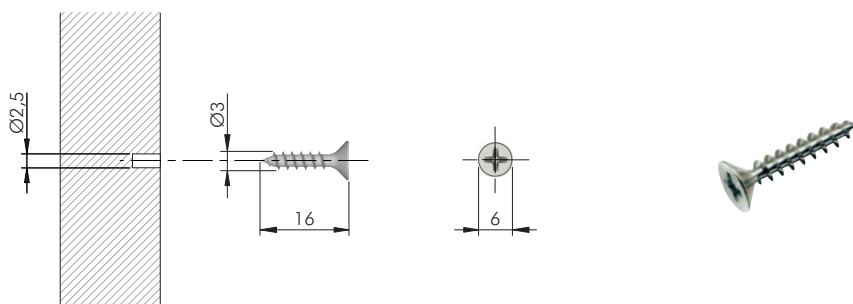

= Ø 2,5 mm +
 = PZ1
 ST = 100 pcs.

123
 60101210ZN

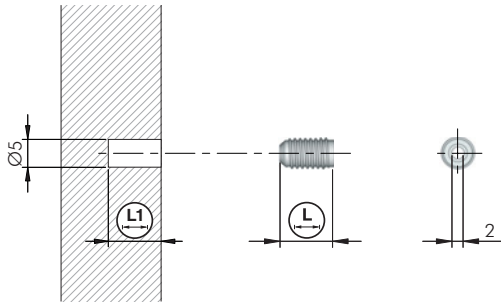

= Ø 5 mm

EPn

= 5000 pcs.



20302020AA



9,5



11,5

20302030AA

13

15

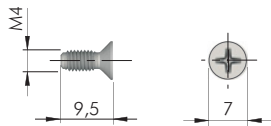

= PZ2



= M4

ST

= 15.000 pcs.



11750010ZN

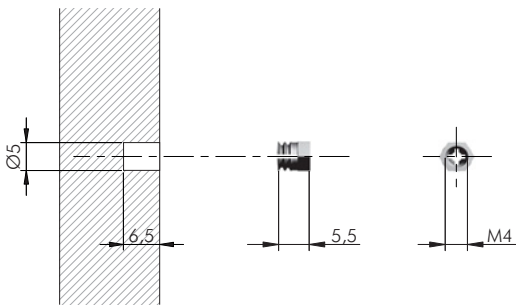

= Ø 5 mm

= M4

BR

= 5000 pcs.



20502000HL

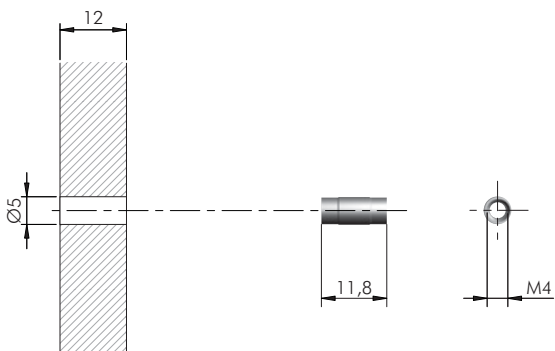

= Ø 5 mm

= 12 mm

= M4

BR

= 5000 pcs.



20801000HL

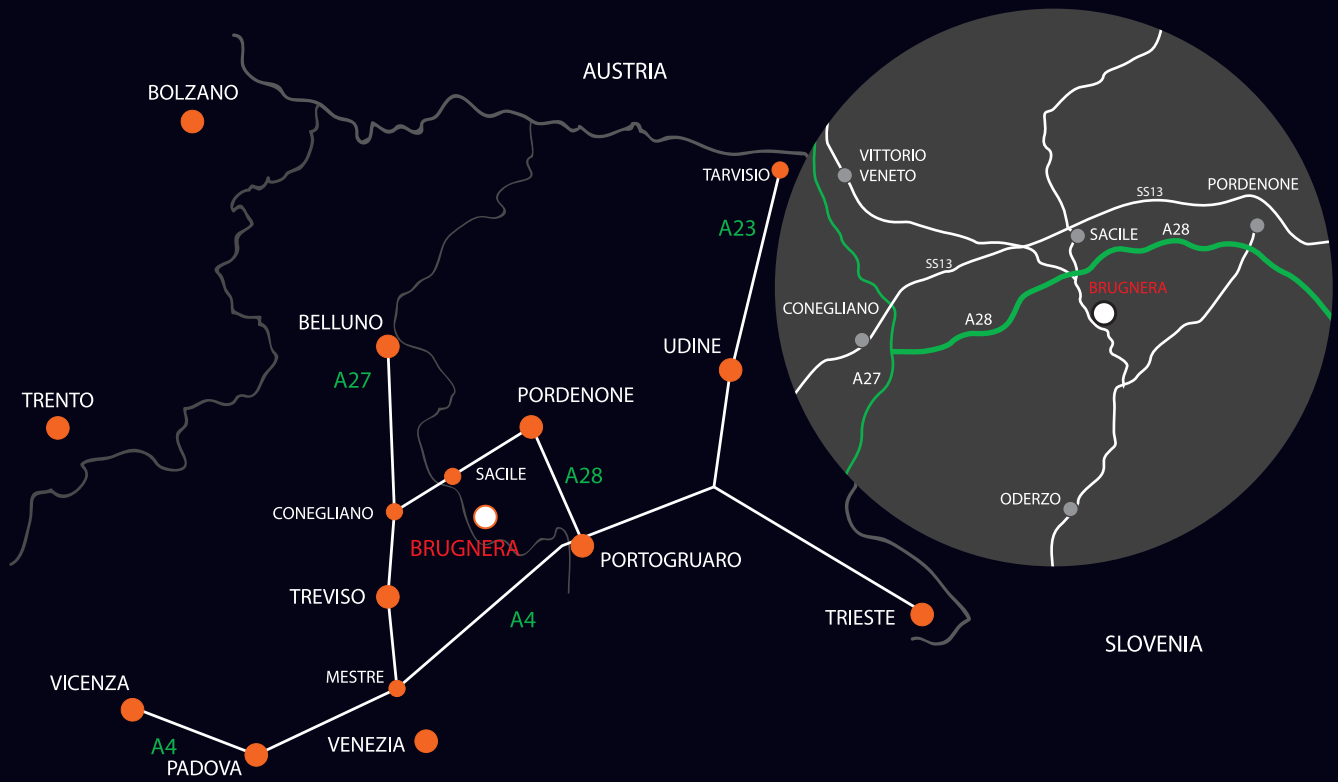

www.italianaferramenta.com